





Onix Installation

Full installation instructions are supplied with the product. Full details of the Ackermann Screed Ducting system can be found in the **Screeded** brochure.

Installation of Cassette Solution and Round Aluminium Floorbox

- 1 The Screed Base Unit, with the Trunking, is assembled onto the slab and the levelled to the height of the screed using the four adjustment screws at each corner. A metal plate supplied with the Screed Base Unit keeps the screed out of the interior of the box.
- 2 The frame is assembled to the when the floor covering is laid. When the Round Aluminium Floorbox is used the adaptor plate (Part number 30316G) must be fitted to the Screed Base Unit. The Screed Base Unit 350 must be used when installing the Round Aluminium floorbox.
- 3 The gasket is supplied as a self adhesive strip and is assembled into the groove to provide a seal against dust and water ingress.
- 4 The lid is supplied with an earth lead and must be bonded to earth for all power applications. As the lid is only installed when the floor covering is laid there is less chance the surface finish of the lid will be damaged.
- 5 A floor covering insert is required for the lid recess. The dimensions for the insert are given in the Lid Recess Dimensions section.
- 6 Sealing compounds are supplied for products that are for use in wet wash environments.

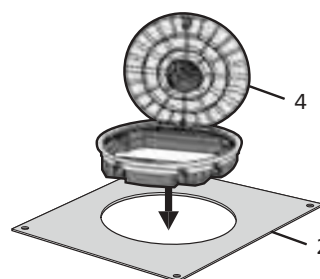
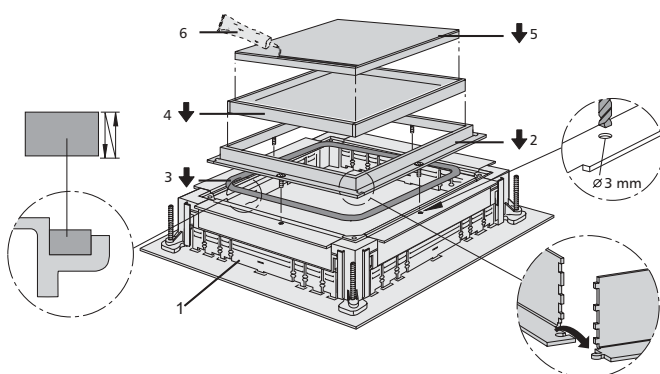

Adaptor plate, part number 30316G, must be fitted when using the Round Aluminium Floorbox.

Installation of Metal Power Grommets

- 1 The Screed Base Unit, with the 20mm diameter conduit is laid onto the concrete slab. There are two Screed Bases available depending on the screed depth.
Screed depth between 60mm and 75mm use 30218B
Screed depth between 60mm and 75mm use 30218C
The threaded collar is adjusted to the height of the screed. A metal plate supplied with the Screed Base Unit keeps the screed out of the interior of the box.
- 2 The lid is installed after the floor covering is laid. The lid is simply screwed into position until tight with the floor.

Sealing for Hard Floor Coverings and Wet Wash Applications

- 3 Adjust the lid leaving a small (approximately 5mm) gap between the lid and the floor.
Run a bead of sealing compound underneath the frame.
- 4 Screw the lid until tight with the floor and wipe away any excess sealant with a damp cloth.

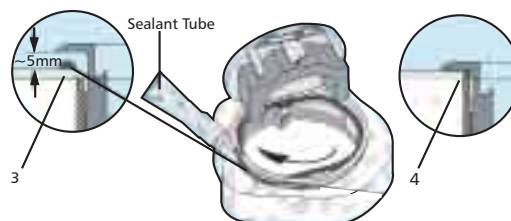
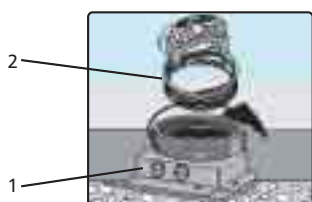

Ackermann



Novar ED&S Ltd The Arnold Centre Paycocke Road Basildon Essex SS14 3EA United Kingdom

Telephone 01268 563252

Fax (UK) 01268 563437

Literature Helpline 0870 240 3391

Technical Helpline 01268 563068

E-mail ackermann@novar-eds.com

Website www.ackermann.co.uk

Registered office: Novar House 24 Queens Road Weybridge Surrey KT13 9UX Registered No. 189291

Literature Ref: Onix AK/04-01-02/004



NI Response III

Novar Intelligent Building Systems offers a uniquely comprehensive range of solutions for specifiers and installers of fire, security, building management, datacoms and electrical installation products and is equipped to provide a single source solution for all your requirements

Onix™ Power Distribution



Ackermann Onix Floorboxes and Power Grommets are a unique, innovative solution to hard floor power and data distribution requirements. Stylish and robust Ackermann Onix provides power and data services in screed floors with coverings such as timber, stone and marble. Used with Ackermann's Screed Ducting system these products can be used in a wide range of applications including reception areas, offices, airports, shopping malls and exhibition halls.

Stylish and subtle

Unique Onix floorboxes can be fitted in a variety of hard floor surfaces providing a stylish, subtle finish.

Robust

The strength of the Ackermann Onix range means that they are the only floorboxes which can be installed in public areas.

Wet Wash

The Ackermann Onix range includes unique products that can be used in areas that will be cleaned using wet wash techniques. The innovative sealing system means that the floor can be washed even when the floorbox is in use.

Onix Applications

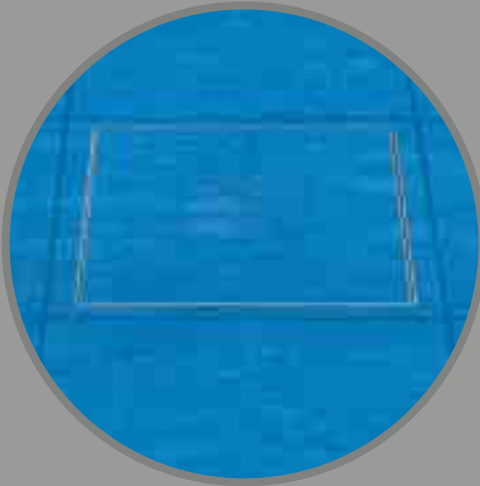

Unobtrusive, the Onix Floorbox with No Cord Outlet allows access to the cabling at junction boxes or can be used to cover services when not in use.

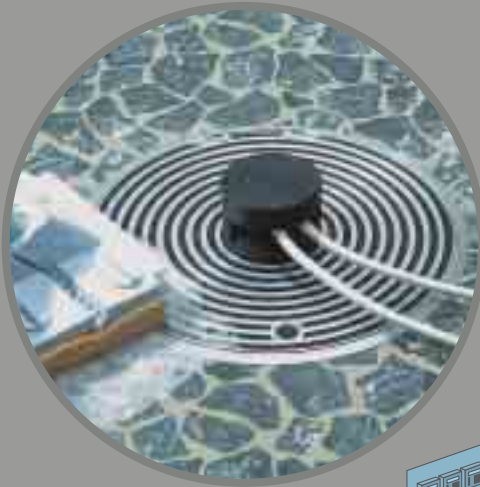

The Round Aluminium Floorbox provides power and data distribution to areas where wet wash techniques are employed, even when it is in use. Manufactured in aluminium the ribbed lid provides a strong, wear resistant non-slip surface.

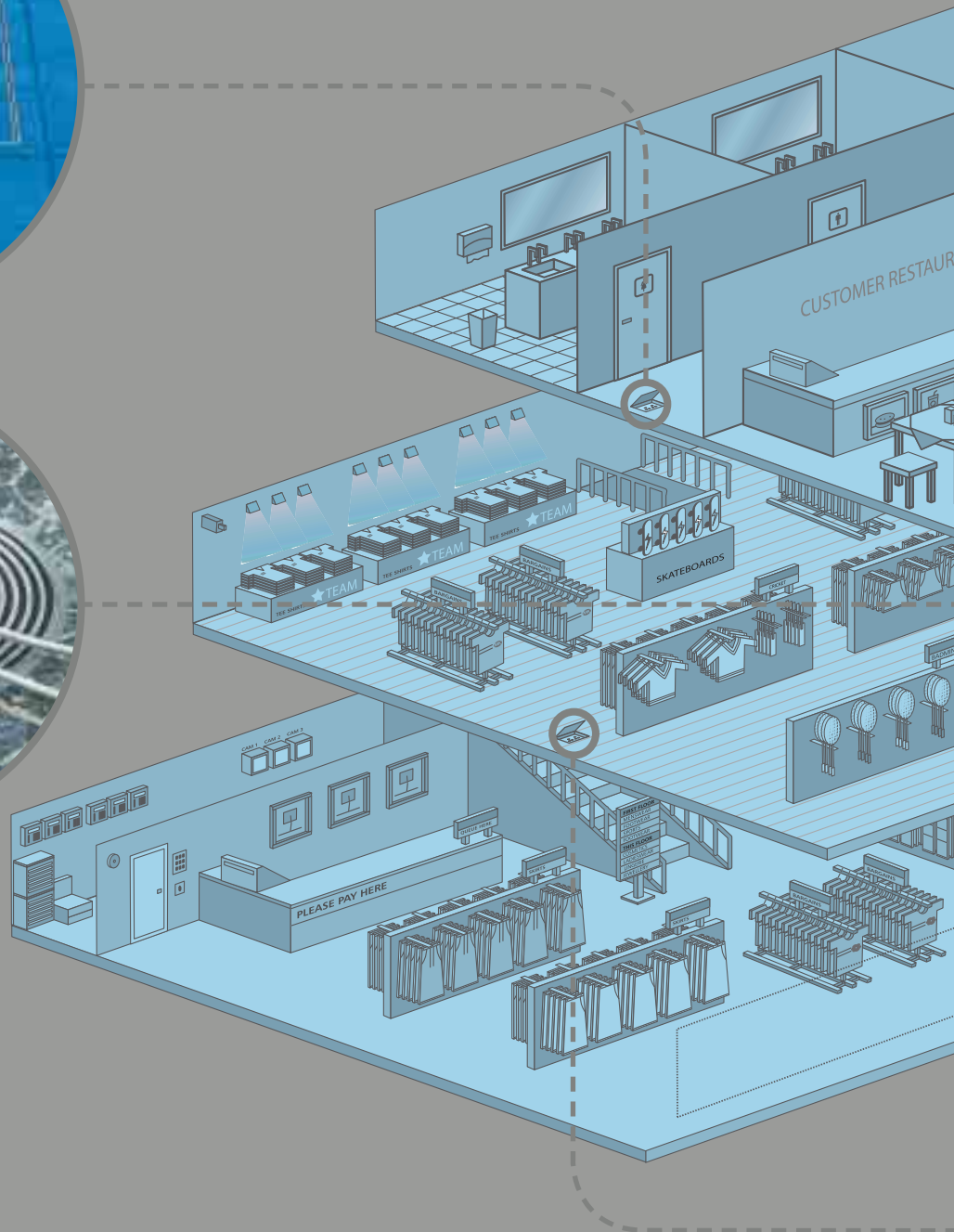

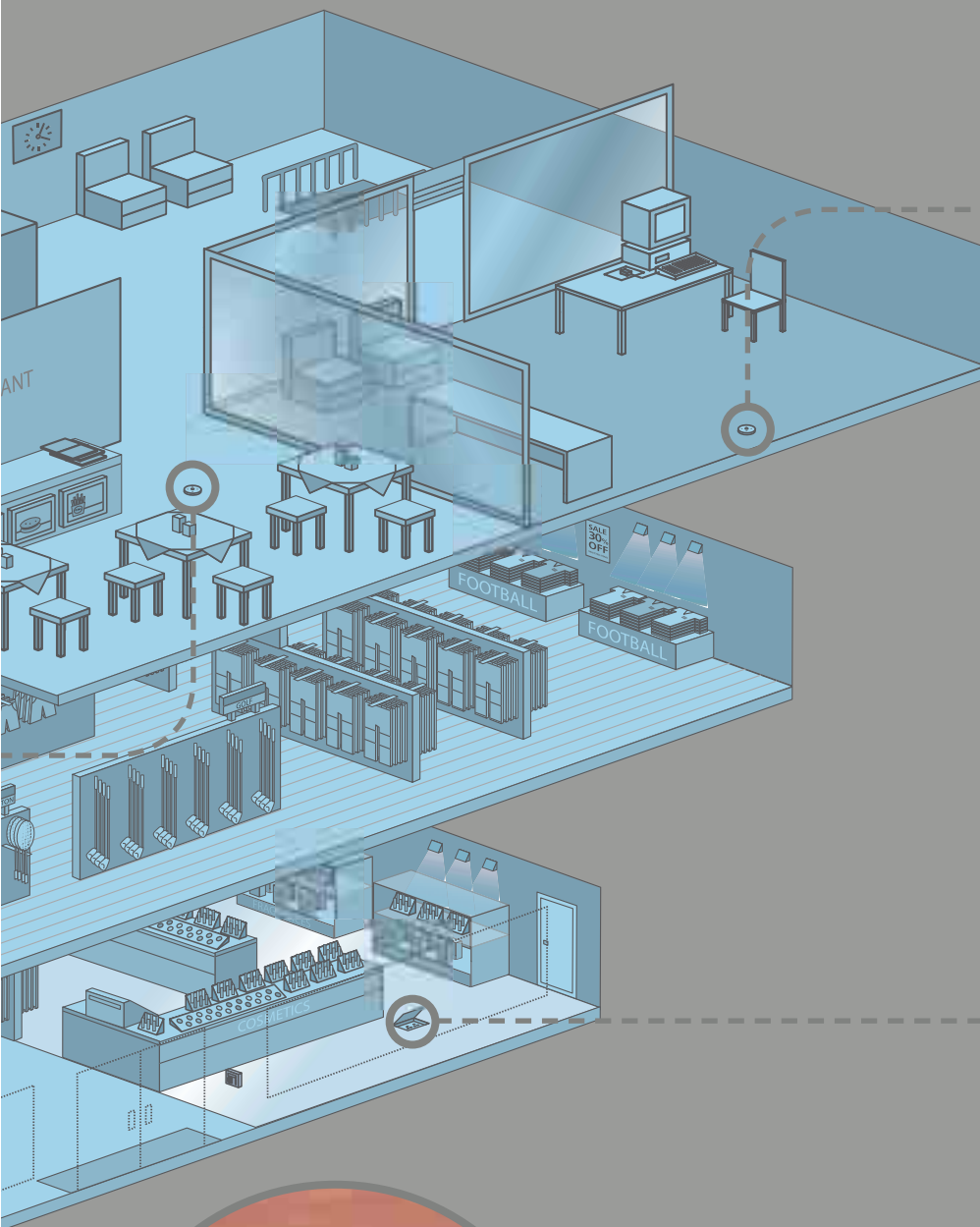

Onix Power Grommets provide a stylish, more robust alternative to standard plastic grommets. These units are also suitable for use in wet wash areas and with all hard floor surfaces.

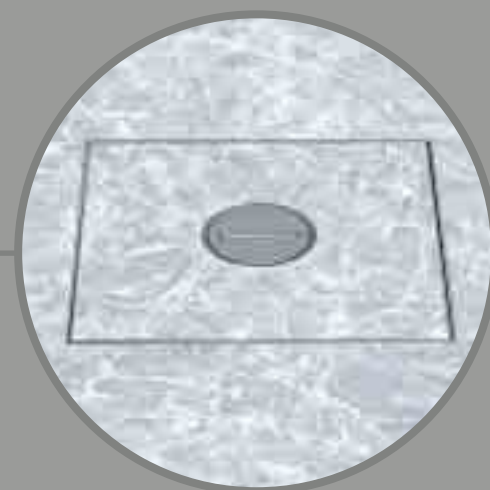

All square floorboxes can accommodate elegant marble finishes. Without compromising on aesthetics the Floorbox with Central Cord Outlet is suitable for wet wash applications, even when it is in use.

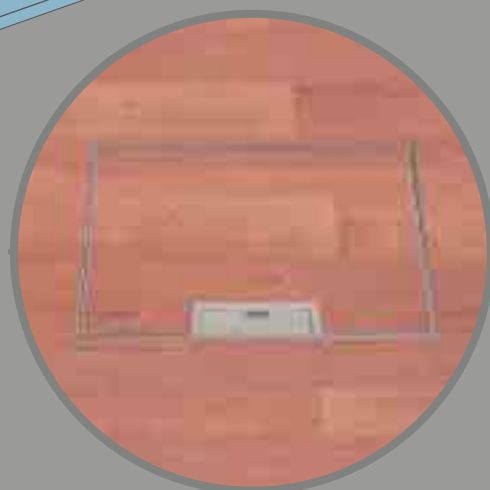

All square floorboxes have the facility to fit flush onto timber flooring, complementing this stylish and contemporary finish. The Floorbox with single outlet is ideal for timber floors which do not require wet wash techniques.

Onix Round Aluminium Floorbox with centre cord outlet



Lid also available in natural aluminium

WET WASH

Unique cord outlet design allows floor to be washed even when Floorbox is in use

WET WASH

Sealing gasket prevents water ingress

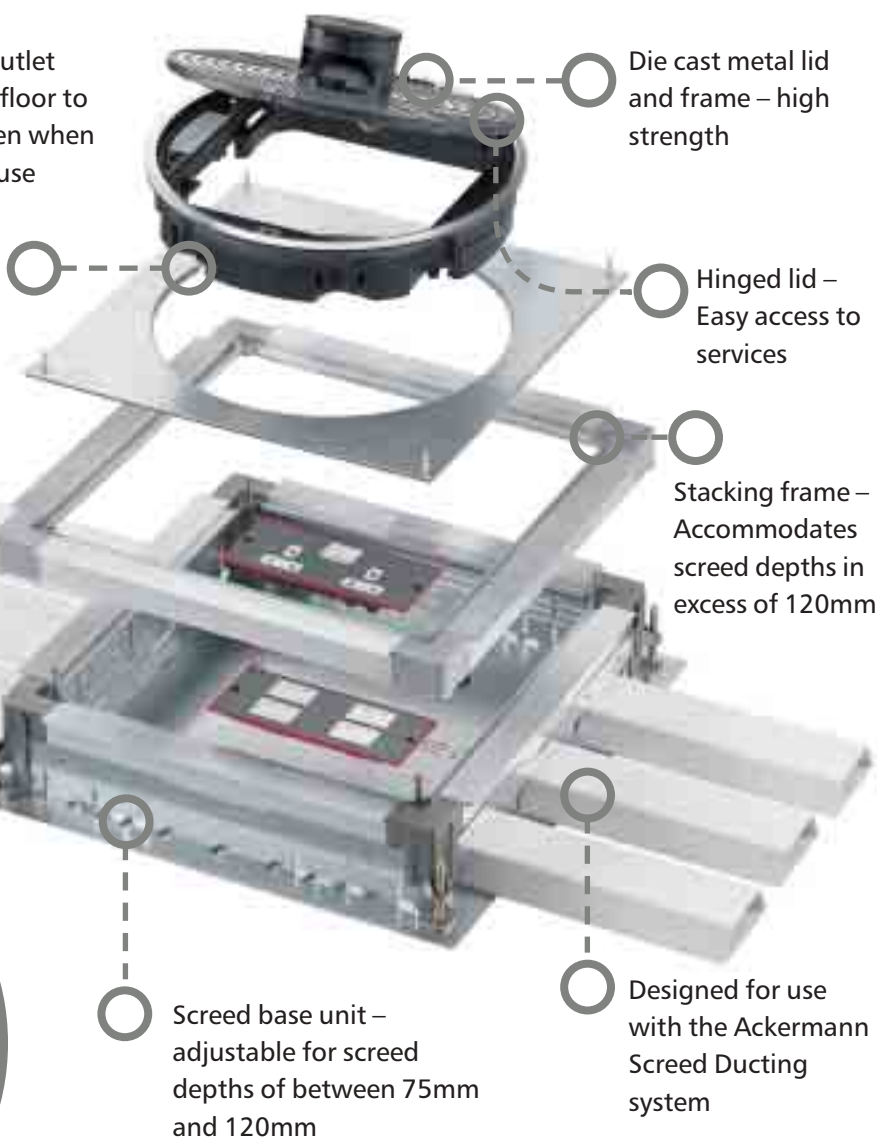

Die cast metal lid and frame – high strength

Hinged lid – Easy access to services

Stacking frame – Accommodates screed depths in excess of 120mm

Aluminium lid with ribbed finish – strong, wear resistant and non-slip surface



Screed base unit – adjustable for screed depths of between 75mm and 120mm

Designed for use with the Ackermann Screed Ducting system

Wet wash

Ackermann's die cast aluminium service outlet box is a revolutionary product that allows power and data services to be easily accessed in areas where wet wash techniques are employed to clean floors. Manufactured in aluminium, with a ribbed finish on the lid that provides a strong, wear resistant and non-slip surface.

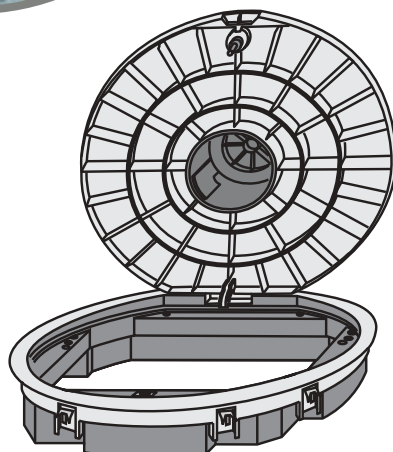

ROUND ALUMINIUM FLOORBOX WITH CENTRE CORD OUTLET

| PART NUMBER | DESCRIPTION |
|-------------|--|
| 30862* | Floorbox 3 comp aluminium with snorkel |

*For **Grey** cord outlets add suffix **A**; for **Black** cord outlets add suffix **F**.

Note: The Screed Base Unit 350 (Part Number 60505C) must be used with this floorbox.

Cord outlet colours

| | |
|-------|----------|
| Grey | RAL 7011 |
| Black | RAL 9011 |

Onix Floorbox with centre cord outlet

WET WASH

Unique cord outlet design allows floor to be washed even when Floorbox is in use

Variety of lid and frame depths – accommodates different types of floor covering

Only cord outlet and edge of frame and lid are visible – very unobtrusive

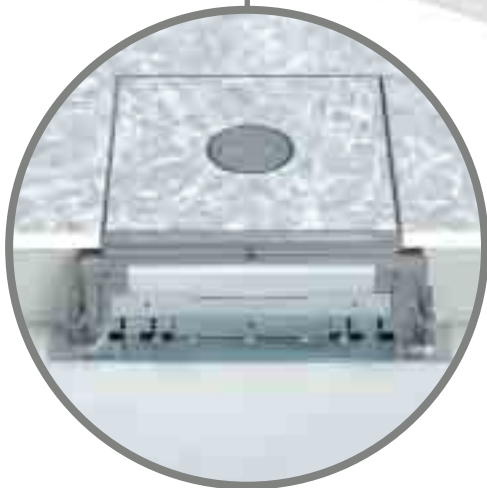

Wet wash

This range of lids incorporate the unique cord outlet that is used for areas where wet wash techniques are used.

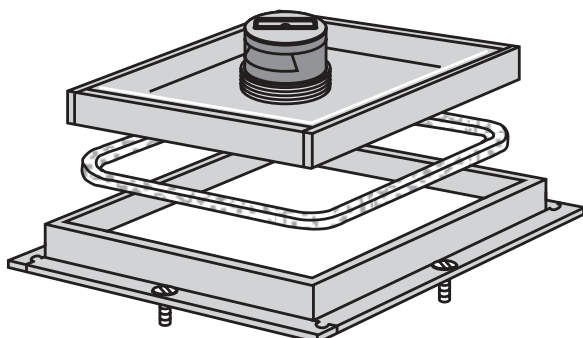

4mm thick steel load plate – high strength

WET WASH
Sealing gasket prevents water ingress

Brushed stainless steel plate – protects cord outlet

Screed base unit – adjustable for screed depths of between 75mm and 120mm

Designed for use with the Ackermann Screed Ducting system

LID WITH CENTRE CORD OUTLET

| PART NUMBER | DESCRIPTION |
|-------------|-------------------------------------|
| 30084A* | Cassette 250 10mm deep with snorkel |
| 30084B* | Cassette 250 15mm deep with snorkel |
| UT30084C* | Cassette 250 20mm deep with snorkel |
| UT30084D* | Cassette 250 25mm deep with snorkel |
| UT30084E* | Cassette 250 30mm deep with snorkel |
| UT30093A* | Cassette 350 10mm deep with snorkel |
| UT30093B* | Cassette 350 15mm deep with snorkel |
| UT30093C* | Cassette 350 20mm deep with snorkel |
| UT30093D* | Cassette 350 25mm deep with snorkel |
| UT30093E* | Cassette 350 30mm deep with snorkel |

*For **Grey** cord outlets add suffix **A**; for **Black** cord outlets add suffix **F**.

Cord outlet colours

Grey RAL 7011
Black RAL 9011

Onix Floorbox with edge cord outlet

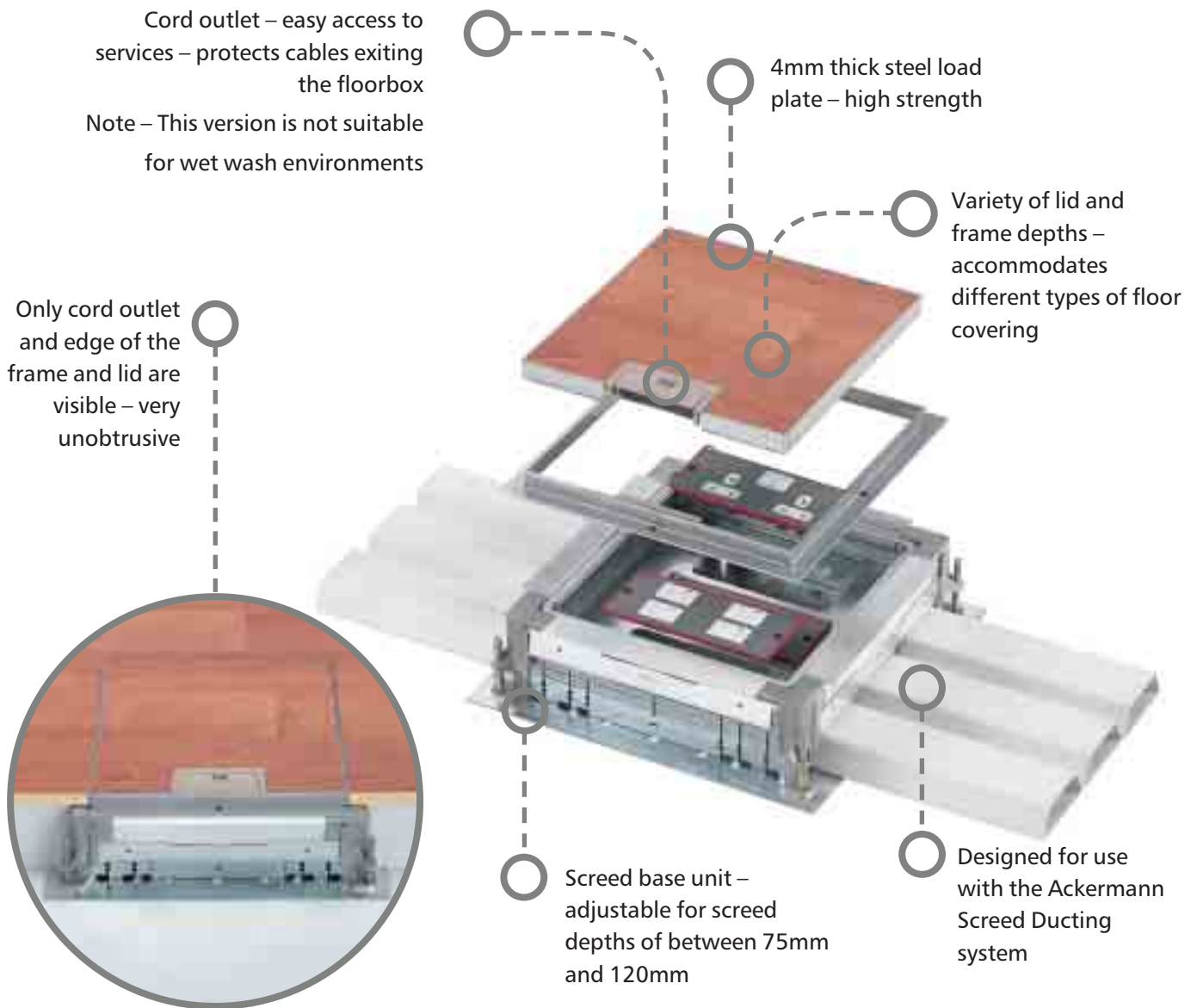

Non Wet wash

This range of lids incorporate a standard cord outlet and is used for floor surfaces that do not require wet wash techniques such as timber floor. Available in two colours, either Grey or Beige.

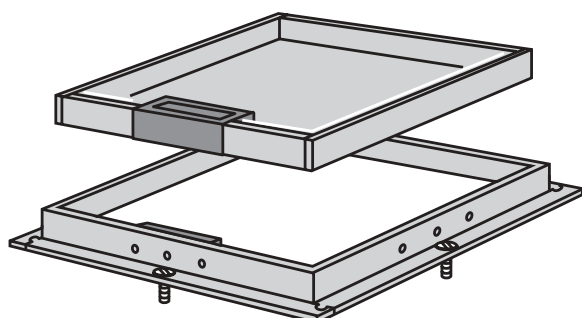

LID WITH EDGE CORD OUTLET

| PART NUMBER | DESCRIPTION |
|-------------|---|
| UT30087B* | Cassette 250 15mm deep with cord outlet |
| UT30087C* | Cassette 250 20mm deep with cord outlet |
| UT30087D* | Cassette 250 25mm deep with cord outlet |
| UT30087E* | Cassette 250 30mm deep with cord outlet |
| UT30066B* | Cassette 350 15mm deep with cord outlet |
| UT30066C* | Cassette 350 20mm deep with cord outlet |
| UT30066D* | Cassette 350 25mm deep with cord outlet |
| UT30066E* | Cassette 350 30mm deep with cord outlet |

*For **Grey** cord outlets add suffix **A**; for **Beige** cord outlets add suffix **E**.

Cord outlet colours

Grey RAL 7011
Beige RAL 1019

Onix Floorbox with no cord outlet

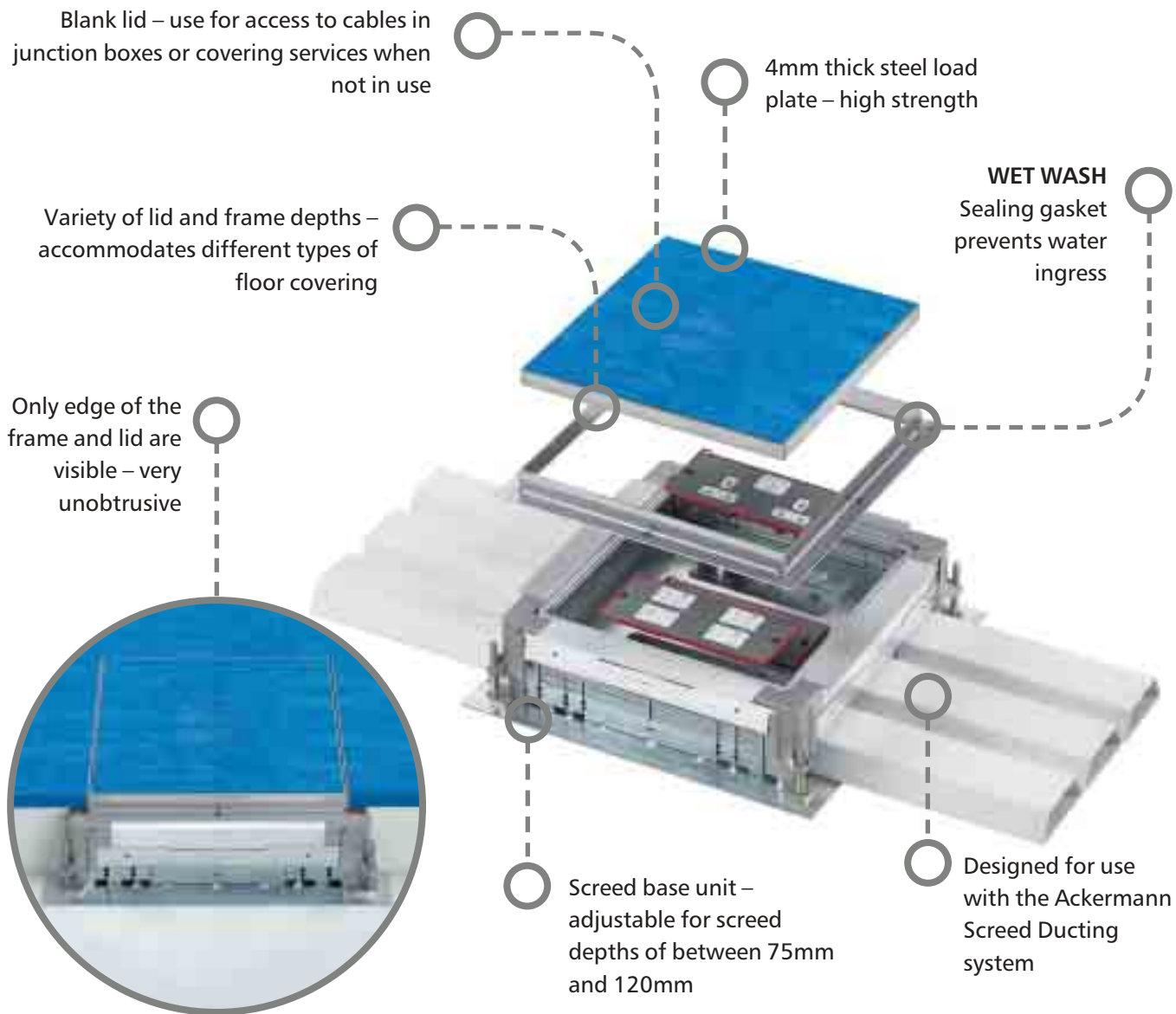

Wet wash

This range of lids incorporate the unique cord outlet that is used for areas where wet wash techniques are used.

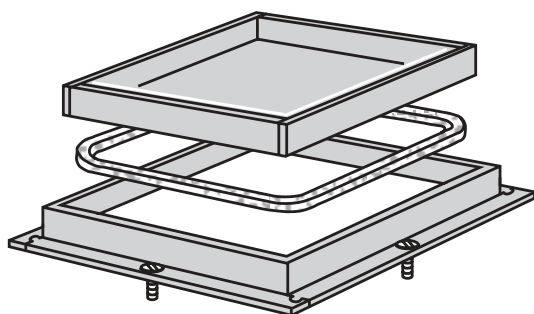

| BLANK LID | |
|-------------|----------------------------------|
| PART NUMBER | DESCRIPTION |
| 30081A | Cassette 250 10mm deep blank lid |
| 30081B | Cassette 250 15mm deep blank lid |
| 30081C | Cassette 250 20mm deep blank lid |
| 30081D | Cassette 250 25mm deep blank lid |
| 30081E | Cassette 250 30mm deep blank lid |
| 30078A | Cassette 350 10mm deep blank lid |
| 30078B | Cassette 350 15mm deep blank lid |
| 30078C | Cassette 350 20mm deep blank lid |
| 30078D | Cassette 350 25mm deep blank lid |
| 30078E | Cassette 350 30mm deep blank lid |

Onix Metal Power Grommet



The range of power grommets provide access to power in areas where standard plastic grommets are not strong enough or where aesthetics are important.

Wet Wash

These units are sealed against water ingress when the lid is closed and are therefore suitable for use in wet wash areas.

Services

The Metal Power Grommets are designed to take either switched or unswitched sockets. When ordering the unit, choose the socket option required and order at the same time. The unswitched socket is supplied with a blanking plate to close off the extra space that would normally be taken by the switch.

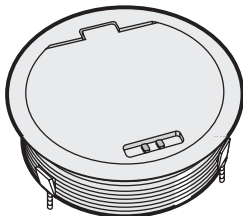

COLOUR OPTIONS
Available in nickel and antiqued brass

| POWER GROMMETS | |
|----------------|-------------------------------|
| PART NUMBER | DESCRIPTION |
| 30953 DA | Power Grommet Unserved Nickel |
| 30953 GA | Power Grommet Unserved Brass |

See opposite page for Screed Base Unit Part Numbers.

Onix Screed Base Units and Accessories

Screed Base Units

The Base Units are installed before the screed is poured.

Adjustable in height to suit screed depths of 70mm up to 120mm the standard unit is designed to interface to the 35mm x 90mm screed ducting from Ackermann's Screed Ducting system.

Adaptor plates are available to allow connection to the 25mm x 60mm ducting or 20mm diameter conduits.

For deeper screed depths 35mm high Stacking Frames can be used to build the Base Unit up to the required height.

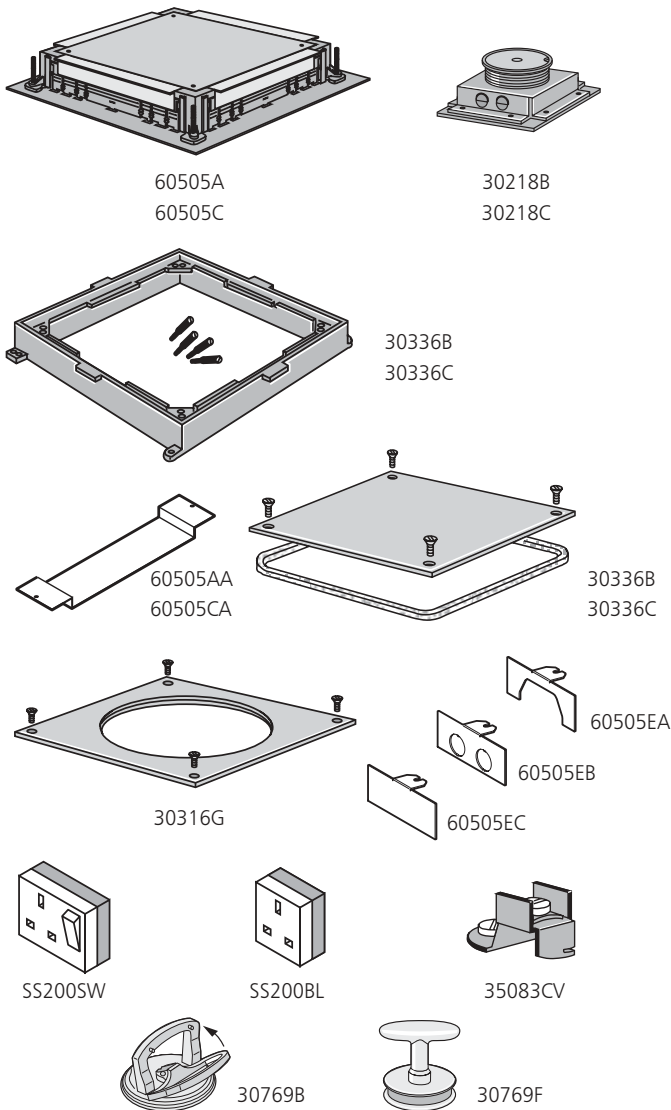

SCREED BASE UNITS

| PART NUMBER | DESCRIPTION |
|-------------|---|
| 60505A | Screed Base Unit 250 to suit SF88100 |
| 60505C | Screed Base Unit 350 to suit SF88100 |
| 30218B | Screed Base Unit for Grommet 60 to 75mm |
| 30218C | Screed Base Unit for Grommet 72 to 91mm |

Use Cablelink Rapide Extra mounting plates for services.
(See Underfloor Distribution Systems Catalogue).

STACKING FRAMES

| PART NUMBER | DESCRIPTION |
|-------------|---------------------------------------|
| 30336B | Stacking Frame 35mm deep for 250 Base |
| 30336C | Stacking Frame 35mm deep for 350 Base |

ACCESSORIES

| PART NUMBER | DESCRIPTION |
|-------------|---|
| 60505AA | Centre plate blank for Screed Base Unit 250 |
| 60505CA | Centre plate blank for Screed Base Unit 350 |
| 30318A | Blind Cover 250 |
| 30316G | Adaptor Plate GRAF9 |
| 60505EA | Adaptor Plate SF88200 (Pack of 3) |
| 60505EB | Adaptor Plate Conduit Entry (Pack of 3) |
| 60505EC | Adaptor Plate Blank (Pack of 3) |
| SS200SW | 13A Switch Socket for Power Grommet |
| SS200BL | 13A Socket for Power Grommet with blank |
| 35083CV | Earth terminal (Pack of 10) |
| 30769B | Tile lifter 400N |
| 30769F | Tile lifter 200N |

Mounting Plates

The standard Ackermann Cablelink Rapide Extra range of Mounting Plates are used for the power and data services in this product range.

An extensive selection is listed in the Ackermann Underfloor Distribution brochure.

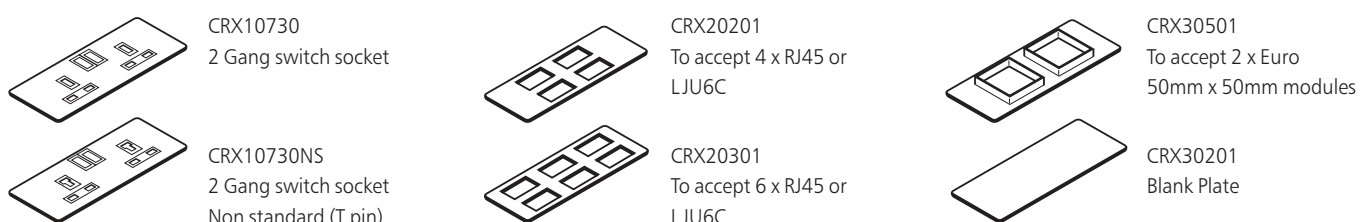

Onix Technical

Mounting plate options for Screed Base Unit 350

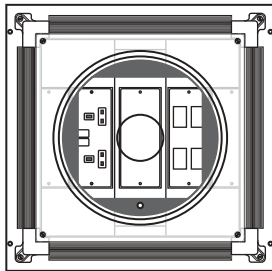

Round Aluminium Floorbox

Only centre 3 mounting plate can be used for services.
Use Blank mounting Plate (Part Number CRX30201) to close off outer 2 mounting plate positions.

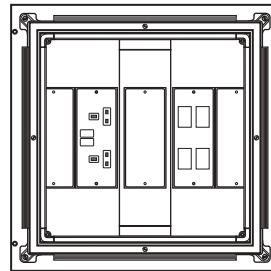

Cassette Lid and Frame

All 5 mounting plate positions can be used. This allows 2 mounting plates for each of the Outer compartments and 1 mounting plate for the Centre compartments.

Centre Cord Outlet Restrictions

This applies to the Round Aluminium Floorbox and the Cassette with Centre Cord Outlet

In certain circumstances the Centre compartment cannot be used for services. The Centre Cord Outlet protrudes into the Area where the Centre compartment mounting plate would normally sit. In these situations the Centre Compartment Blank Plate must be used. The compartment can still be used for cables.

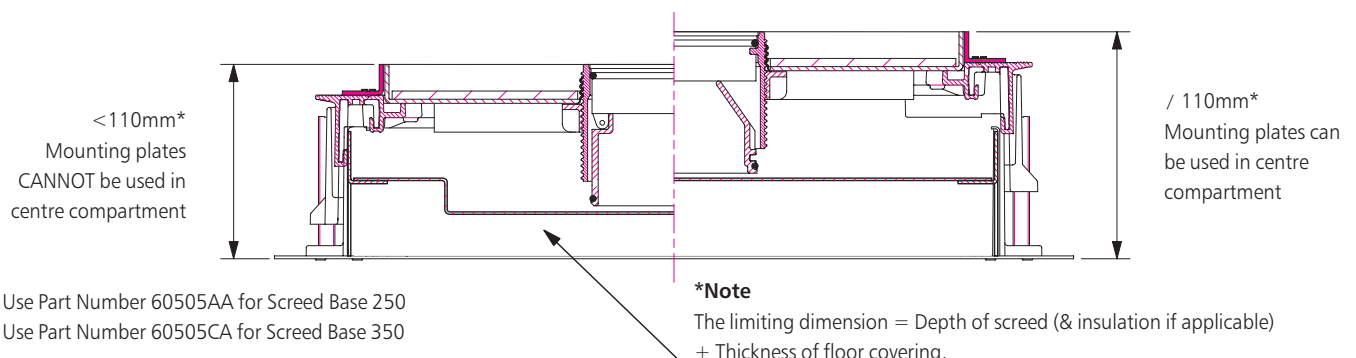

Materials

Round Aluminium Floorbox

Lid and Frame manufactured in diecast Aluminium. Centre Cord Outlet Mouldings are manufactured in a fire retardant grade of Polyamide.

Cassette Lid and Frames

Lid and Frame manufactured in Stainless Steel. Load Plate manufactured in 4mm thick galvanised steel. Cord Outlet Mouldings are manufactured in a fire retardant grade of Polyamide.

Power Grommet

Service outlet is diecast zinc. All visible surfaces are galvanized. Mouldings are manufactured in a fire retardant grade of Polyamide.

Screed Base Units

Levelling frame manufactured from diecast or extruded Aluminium. Base and side walls manufactured in Galvanised Steel.

Wet Wash Test

These floor service units pass the immersion test in DIN VDE 0634 Part 1 which means the floor can be washed even with the cord outlet raised.

The test involves immersing the floorbox (installed in accordance with the manufacturers instructions) under 10mm of water for 10 minutes. The product passes if there is no ingress of water.

Mechanical Strength

These products are designed to withstand the normal traffic load as applicable for office buildings. Tests are described in DIN VDE 0634 part 1 + 2.

The lid is loaded using a force of 1,500N via a cylinder (diameter = 50mm, width = 20mm) for a period of 2 minutes. During the load test the normal function of the test unit must not be restricted. 5 minutes after removal of the load the remaining deflection of the test unit is measured. Test is passed if remaining deflections are less than 1.5mm.

All the products exceed the requirements of this test. Further advice regarding the strength of this range is available through the Technical Helpline.

Onix Technical

Cassette Lid Recess Dimensions

The dimensions in the table provide the sizes for the floor covering insert for the lid.

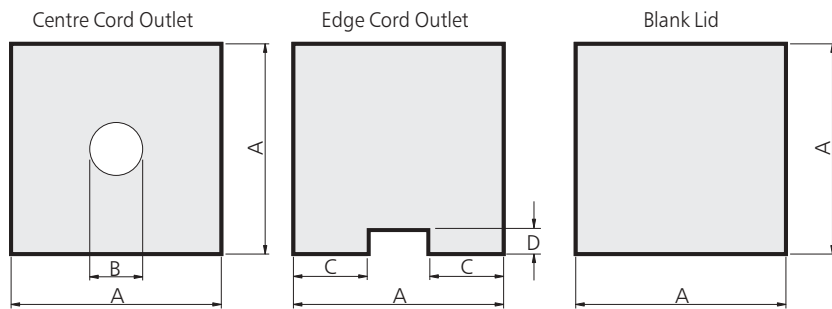

| DIMENSIONS (mm) | | | | |
|-----------------|-----|-----|-----|------|
| | A | B | C | D |
| Cassette 250 | 278 | 100 | 87 | 44.5 |
| Cassette 350 | 378 | 100 | 137 | 44.5 |

Note The recess in the lid is 2mm less than the nominal depth of the Cassette (i.e. a 25mm deep Cassette has a 23mm deep recess in the lid). Due to the weight of the lid and floor covering, a tile lifter, and not the cord outlets, should not be used to lift these lids.

Screed Base Unit Dimensions

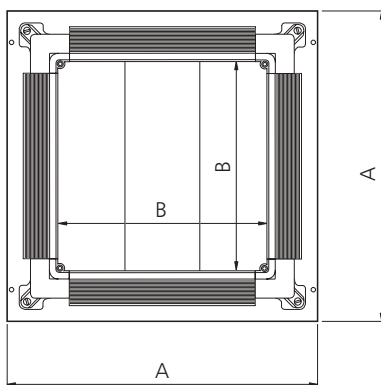

| DIMENSIONS (mm) | | |
|----------------------|-----|-----|
| | A | B |
| Screed Base Unit 250 | 390 | 260 |
| Screed Base Unit 350 | 490 | 360 |

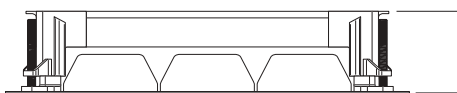

Use 35mm deep Stacking Frame on top of the Screed Base Unit for screed depths in excess of 120mm

Screed Depth Range
= 75mm to 120.0mm

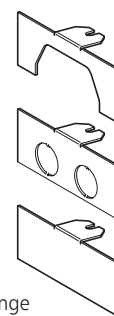

60505EA
For 25mm x 60mm
ducting (SF88200)

60505EB
For 20mm diameter
conduit

60505EC
To blank off ducting
aperture

The Screed Base units are designed to accept the 35mm x 90mm Ackermann screed ducting (Part number SD88100) system. When used with the smaller 25mm x 60mm (Part number SF88200) ducting, the adaptor plate, Part number 60505EA, must be used.

Adaptor plate, Part number 60505EB, is available for use with 20mm diameter conduit.

Where the Screed Base Unit is at the end of a run, the blank adaptor plate, Part number 60505EC, can be used to cover unused ducting apertures.

Round Aluminium Floorbox Dimensions

This Floorbox must be used in conjunction with the Screed Base Unit 350, Part Number 30505C and Adaptor Plate, Part Number 30316G.

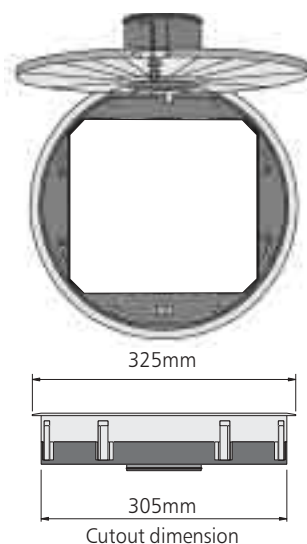

Metal Power Grommet Dimensions

The Metal Power Grommet is designed to be used in conjunction with the Screed Base Unit, Part Number 30218B or 30218C, depending on the depth of the screed.

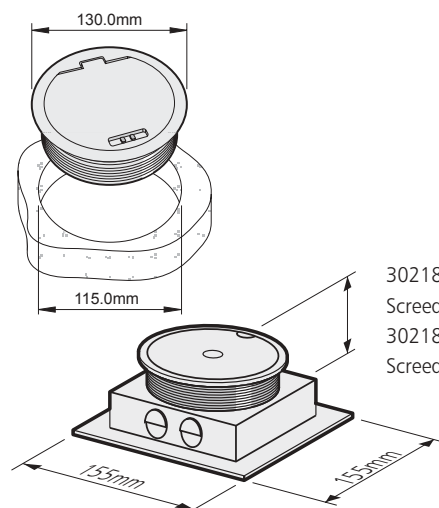

30218B
Screed Depth = 60mm to 75mm

30218C
Screed Depth = 72mm to 91mm